

## Anti-Lock Brake System (ABS) Module

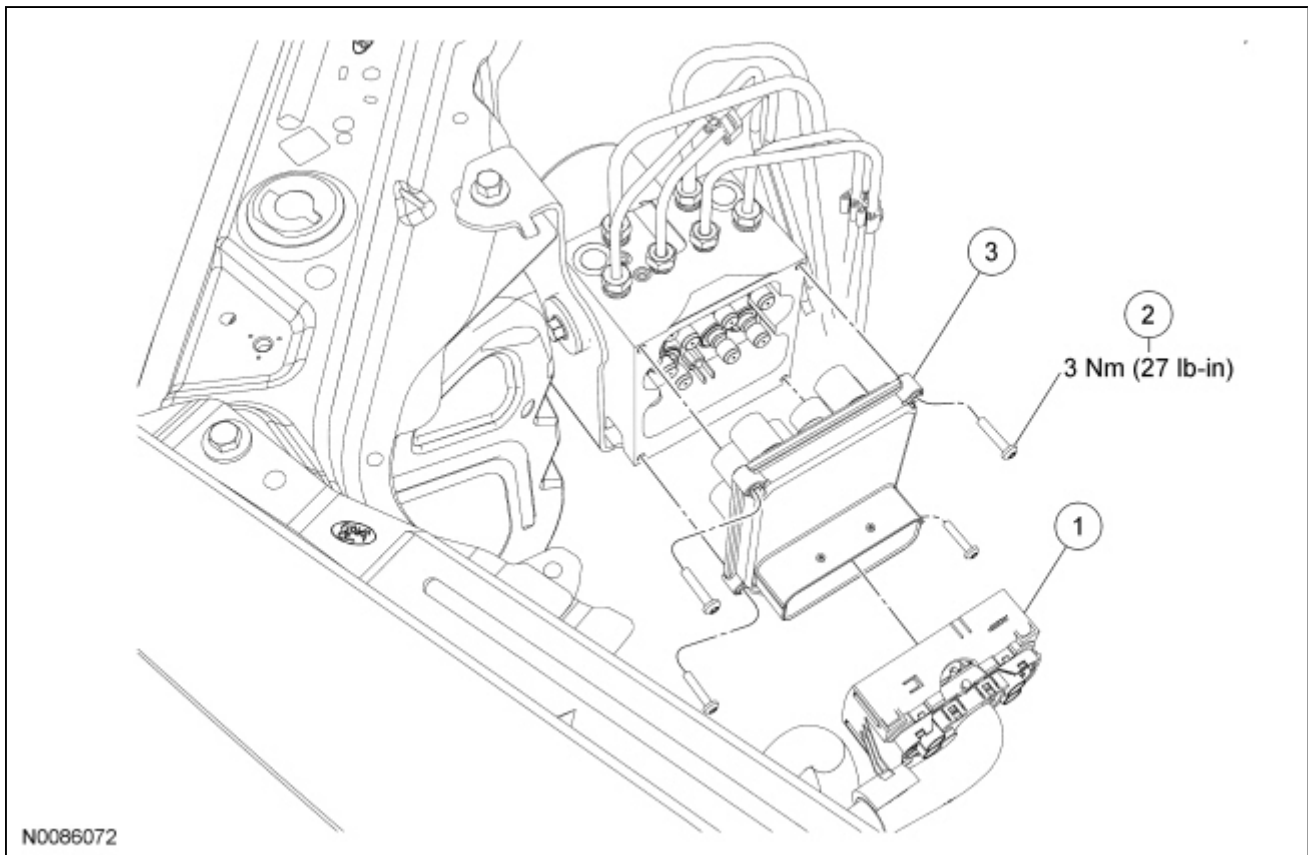

Item	Part Number	Description
1	—	ABS module electrical connector (part of 14A005)
2	ZD061	ABS module screw (4 required)
3	2C219	ABS module

### Removal and Installation

**NOTICE:** Electronic modules are sensitive to electrical charges. The anti-lock brake system (ABS) module can be damaged if exposed to these charges.

1. Remove the air cleaner assembly. For additional information, refer to [Section 303-12](#).
2. Disconnect the ABS module electrical connector.
3. Remove the 4 screws and the ABS module.
  - To install, tighten to 3 Nm (27 lb-in) in the sequence shown.

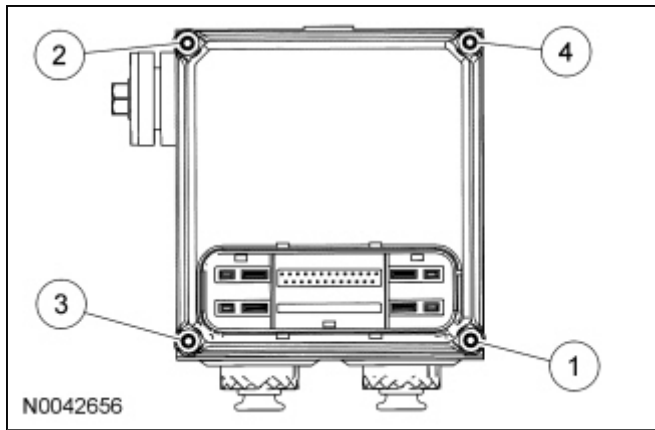

4. To install, reverse the removal procedure.
-